

Moulinex  
uno

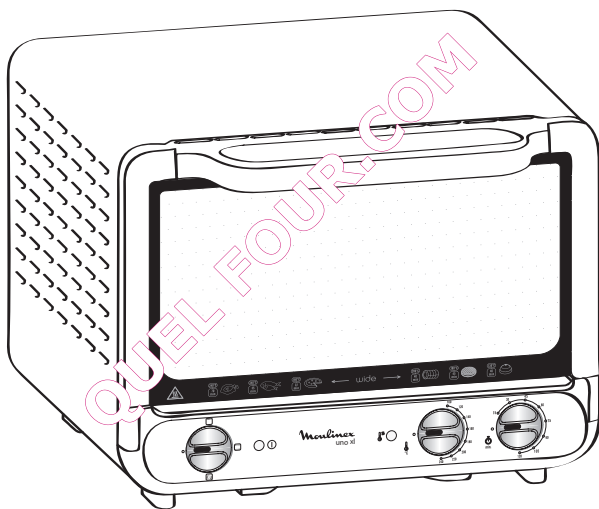

FR

EN

DE

NL

IT

ES

PT

EL

AR

FA

[www.moulinex.com](http://www.moulinex.com)

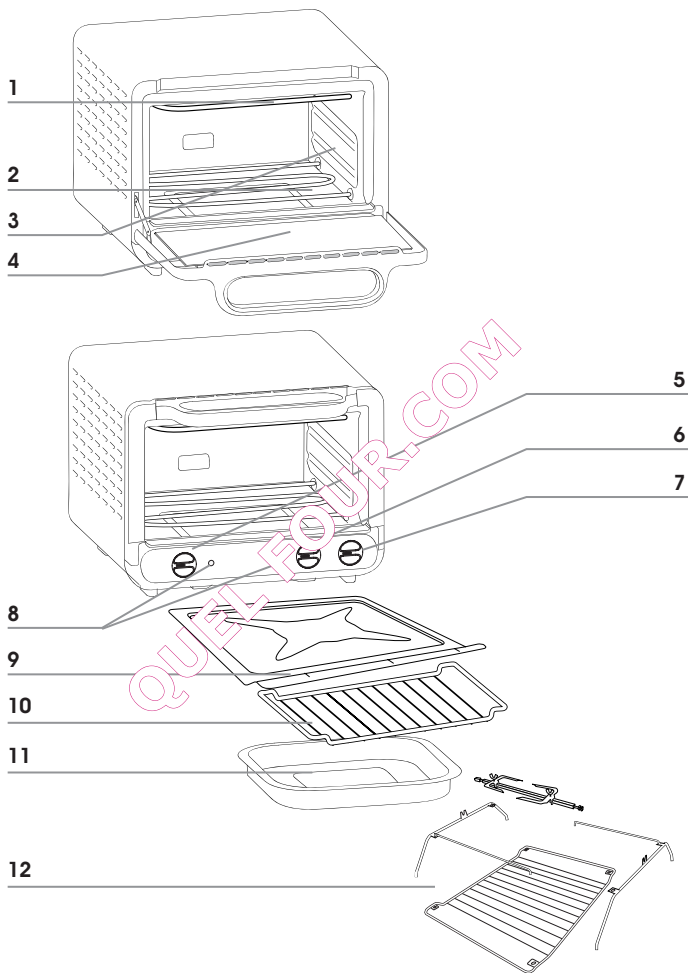

\* Selon modèle - depending on model - Je nach Modell - afhankelijk van het model - secondo il modello - según modelo - Consoante os modelos - ανάλογα με το μοντέλο

## DESCRIPTION

1. Résistance supérieure
2. Résistance inférieure
3. Parois non stick
4. Porte double parois
5. Bouton des fonctions
6. Bouton de réglage température
7. Bouton de minuterie
8. Voyants de fonctionnement
9. Sole ramasse miettes
10. Grille réversible
11. Plat non adhésif
12. Kit tournebroche (1 grille, 2 fourches, 2 supports broche, 1 tige, 1 plat)

## DESCRIPTION

1. Top heating element
2. Bottom heating element
3. Non-stick walls
4. Double-wall door
5. Function buttons
6. Temperature control button
7. Timer button
8. Power indicator lights
9. Crumb tray
10. Reversible shelf
11. Non-stick oven tray
12. Rotisserie kit (1 grill, 2 forks, 2 meat holders, 1 spit rod, 1 plate)

## BESCHREIBUNG

1. Oberes Heizelement
2. Unteres Heizelement
3. Antihafbeschichtete Wände
4. Doppelwandige Tür
5. Funktionsknöpfe
6. Temperaturregler
7. Timer-Knopf
8. Betriebsleuchten
9. Krümelblech
10. Umkehrbarer Rost
11. Antihafbeschichtete Backform
12. Drehspieß-Set (1 Rost, 2 Gabeln, 2 Spießhalterungen, 1 Spieß, 1 Schale)

## BESCHRIJVING

1. Bovenste verwarmingselement
2. Onderste verwarmingselement
3. Anti-aanbakwanden
4. Dubbelwandige deur
5. Functieknoppen
6. Temperatuurregelknop
7. Timerknop
8. Aan/uit-controlelampjes
9. Kruimellade
10. Omkeerbaar rooster
11. Anti-aanbakovenschaal
12. Draaispijset ( 1 rooster, 2 vorken, 2 spithouders, 1 stang, 1 schaal)

## DESCRIPCIÓN

1. Resistencia superior
2. Resistencia inferior
3. Paredes antiadherentes
4. Puerta de doble cristal
5. Botones de funciones
6. Botón de ajuste de temperatura
7. Botón de temporizador
8. Pilotos de funcionamiento
9. Bandeja recogemigas
10. Rejilla reversible
11. Fuente antiadherente
12. Kit de asador (1 rejilla, 2 tenedores, 2 soportes para brocheta, 1 varilla, 1 fuente)

## DESCRIPTION

1. Resistência superior
2. Resistência inferior
3. Paredes antiaderentes
4. Porta de parede dupla
5. Botões das funções
6. Botão de regulação da temperatura
7. Botão temporizador
8. Indicadores de funcionamento
9. Bandeja para migalhas
10. Grelha reversível
11. Prato não aderente
12. Kit espeto rotativo (1 grelha, 2 forquilhas, 2 suportes para espeto, 1 haste, 1 prato)

## DESCRIZIONE

1. Resistenza superiore
2. Resistenza inferiore
3. Pareti anti-adesive
4. Sportello a parete doppia
5. Pulsanti delle funzioni
6. Manopola di regolazione della temperatura
7. Manopola del timer
8. Spie di funzionamento
9. Fondo raccogli-briciole
10. Griglia reversibile
11. Piatto non adesivo
12. Kit girarrosto (1 griglia, 2 forcelle, 2 supporti per spiedo, 1 asta, 1 piatto)

## περιγραφή

1. Αντίσταση στο επάνω μέρος
2. Αντίσταση στο κάτω μέρος
3. Αντικολλητικοί τοίχοι
4. Διπλής αντοχής πόρτα
5. Κουμπιά λειτουργιών
6. Κουμπιά θερμοκρασίας
7. Χρονόμετρο
8. Φωτεινή ένδειξη λειτουργίας
9. Ψυχροσυλλέκτης
10. Ράφι διπλής όψης
11. Αντικολλητικός δίσκος
12. Kit περιστροφής (1 εσχάρα, 2 δίσκοι, 2 στηρίγματα σούβλας, 1 σούβλα, 1 ταψί)

## الوصف

1. مقاومة أعلى
2. مقاومة أدنى
3. جدار غير لاصق
4. باب بجدار مزدوج
5. زر التشغيل
6. زر تعديل الحرارة
7. زر التوقيت
8. أضواء التشغيل
9. أرضية لجمع الفتات
10. شواية تعمل بالاتجاهين
11. طبق مقاوم لللصق
12. عدة الشواية (1 قلاية، 2 شوكة، 2 دعامة لسبخ الشواء، 1 ذراع، 1 طبق

- شرح
1. استحکام عالی
  2. مقاومت کمتر
  3. دیواره نجسب
  4. دیواره دو جداره
  5. دکمه انتخاب عملکردها
  6. دکمه تنظیم دما
  7. دکمه زمان سنج
  8. نشانگرهای عملکرد
  9. دارای اشغال جمع کن
  10. توری برگشت پذیر
  11. سطح نجسب
  12. کیت کباب/پزیان کردن (1 عدد توری، 2 عدد چنگال، 2 عدد گیره نگهدارنده، 1 عدد میله گردان، 1 عدد بشقاب

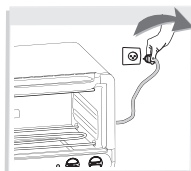
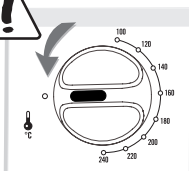
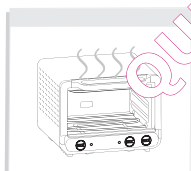
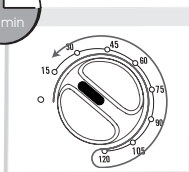
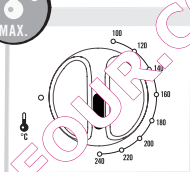
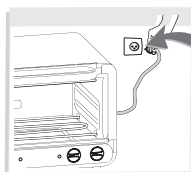
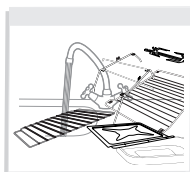
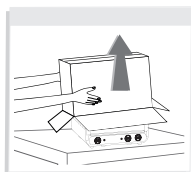
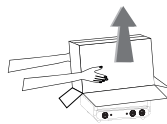

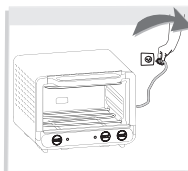
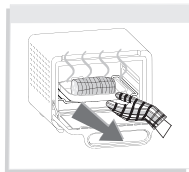
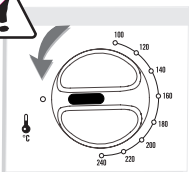
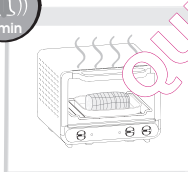
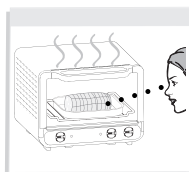
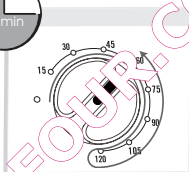
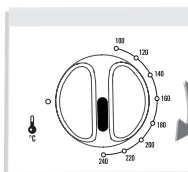
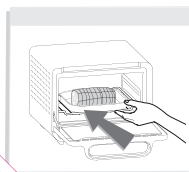
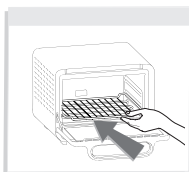
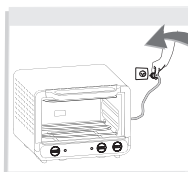

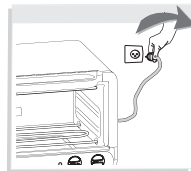
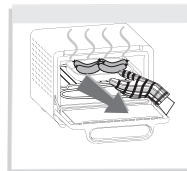
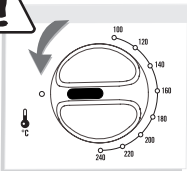
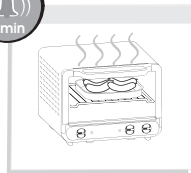
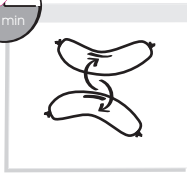
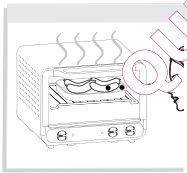
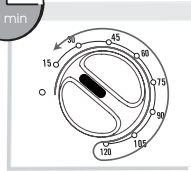
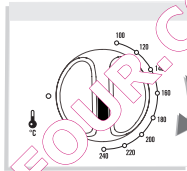
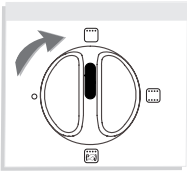
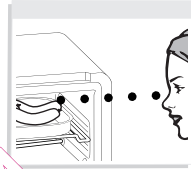
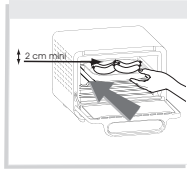
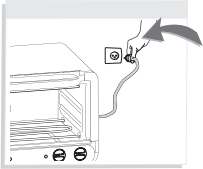

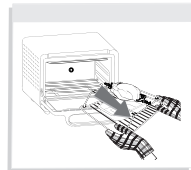
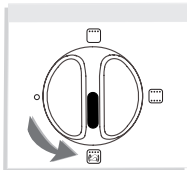
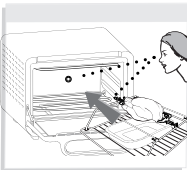
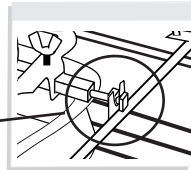
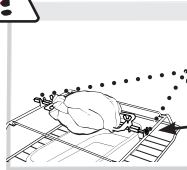
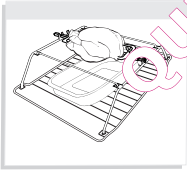
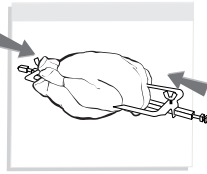
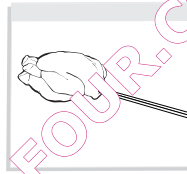
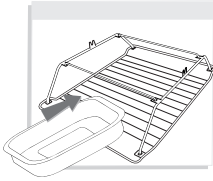
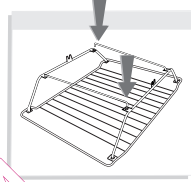
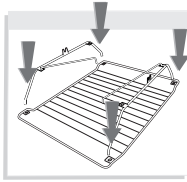



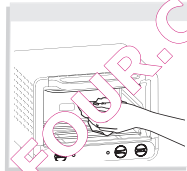
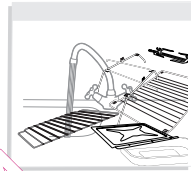
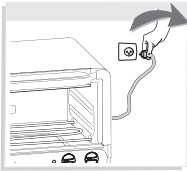





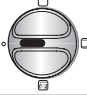
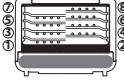







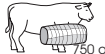

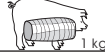

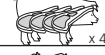













QUELFOUR.COM

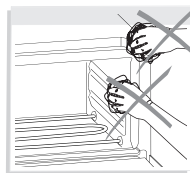
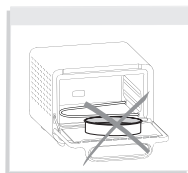
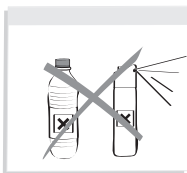
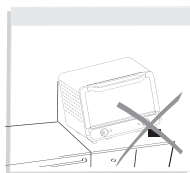
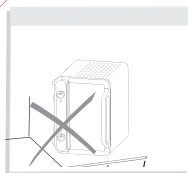
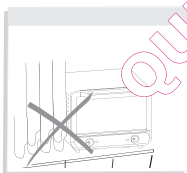
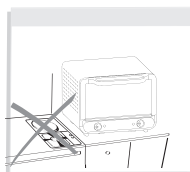
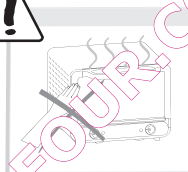
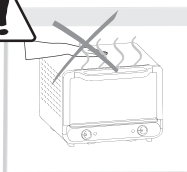
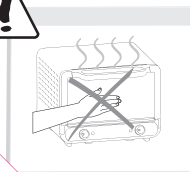
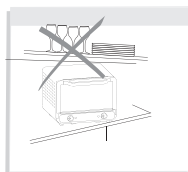
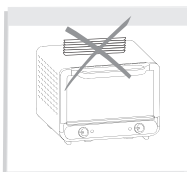





			 °C	Préchauffage Preheat	 min.
		4	240	10 min	20 min
 1,5 kg		3	220	-	70 min
		-	-	-	80 min
 750 g		4	240	10 min	20 min
 1 kg		5	240	-	80 min
 x 4		7	-	10 min	20 + 10 min
 x 9		7	-	-	8 + 13 min
		4	210	-	30 min
		2	210	10 min	65 min
		3	220	10 min	25 min
		4	240	-	25 min
		3	180	10 min	50 min
		4	180	10 min	30 min



 : [www.moulinex.com](http://www.moulinex.com)

			
<b>ALGERIA</b>	GRUPE SEB EXPORT Chemin du Petit Bois, Les 4M 69130 ECULLY - FRANCE	<b>213-41-28-18-53</b>	1 year
<b>ARGENTINA</b>	GRUPE SEB ARGENTINA S.A. Billinghurst 1833 3° C1425DTK Capital Federal Buenos Aires	<b>0800-122-2732</b>	2 años
<b>ՀԱՅԱՍՏԱՆ ARMENIA</b>	«Գրուպա ՄԵԲ-Վոստոկ»ՓԲԸ, 119180 Մոսկվա, Ռուսաստան Ստարոմոնետնիկ կրք., ս.14, շ.2	<b>(010) 55-76-07</b>	2 տարի/ years
<b>AUSTRALIA</b>	GRUPE SEB AUSTRALIA PO Box 7535, Silverwater NSW 2128	<b>02 97487944</b>	1 year
<b>ÖSTERREICH</b>	SEB ÖSTERREICH HmbH Campus 21 - Businesspark Wien Süd Liebermannstr. A02 702 2345 Brunn am Gebirge	<b>6 70 299 00</b>	2 Jahre
<b>BELGIQUE / BELGIE</b>	GRUPE SEB BELGIUM SA NV 25 avenue de l'Espérance - ZI 6220 Fleurus	<b>32 70 23 31 59</b>	2 ans / years
<b>БЕЛАРУСЬ / BELARUS</b>	ЗАО «Группа СЕБ-Востока», 119180 Москва, Россия Старомонетный пер. д. 14	<b>017 2239290</b>	2 года/ years
<b>BOSNA I HERCEGOVINA</b>	SEB Développement et Préfabrication Via 710 / Srebo	<b>Info-linija za potrošače 033 551 220</b>	2 godine
<b>BRASIL</b>	GRUPO SEB PRODUTOS LÍQUIDOS LTDA Aven. Armando, 146 Mooca 03108-00 São Paulo SP	<b>0800-119933</b>	1 ano
<b>БЪЛГАРИЯ/ BULGARIA</b>	ГРУП СЕБ БЪЛГАРИЯ ЕООД Средна 52 Г. ет. 1, офис 1, 1880 София	<b>0700 10 330</b>	2 години
<b>CANADA</b>	GRUPE SEB CANADA 345 Passmore Avenue Toronto, ON M1V 3N8	<b>1-800-418-3325</b>	1 year
<b>CHILE</b>	GRUPE SEB CHILE Comercial Ltda Avda. Nueva Los Leones 0252 Providencia, Santiago	<b>+56 2 232 77 22</b>	2 años
<b>COLOMBIA</b>	GRUPE SEB COLOMBIA Apartado Aereo 172, Kilometro 1 Via Zipaquirá Cajica Cundinamarca	<b>18000919288</b>	2 años
<b>HRVATSKA Croatia</b>	SEB Développement S.A.S. Vodnjanska 26 10000 Zagreb	<b>01 30 15 294</b>	2 godine
<b>ČESKÁ REPUBLIK / CZECH REPUBLIC</b>	GRUPE SEB CR spol. s r. o. Jankovcova 1569/2c 170 00 Praha 7	<b>731 010 111</b>	2 roky
<b>DANMARK</b>	GRUPE SEB NORDIC AS Tempovej 27 2750 Ballerup	<b>44 663 155</b>	2 år
<b>DEUTSCHLAND</b>	GRUPE SEB DEUTSCHLAND GmbH / KRUPS GmbH Herrrainweg 5 63067 Offenbach	<b>0212 387 400</b>	2 Jahre





 : [www.moulinex.com](http://www.moulinex.com)

			
<b>EESTI/ ESTONIA</b>	GRUPE SEB POLSKA SP Z O.O. ul. Ostrobramska 79 04-175 Warszawa	<b>5 800 3777</b>	2 aastat
<b>SUOMI / FINLAND</b>	Groupe SEB Finland Kutojantie 7 02630 Espoo	<b>09 622 94 20</b>	2 Vuotta
<b>FRANCE</b> Inclus Martinique, Guadeloupe, Réunion & St. Martin	GRUPE SEB France SAS Place Ambroise Courtois 69355 Lyon Cedex 08	<b>09 74 50 10 14</b>	1 an
<b>GREECE / ΒΛΛΑΔΑ</b>	SEB GROUPE ΕΛΛΑΔΟΣ Α.Ε. Οδός Φραγκοκλησιάς 7 Τ.Κ. 151 25 Παράδεισος Αμαρουσίου	<b>2106371251</b>	2 χρόνια
<b>HONG KONG</b>	SEB ASIA Ltd. Room 901, 9/F, North Block, Skyway House 3 Sham Mong Road, Tai Kok Tsui, Kowloon	<b>852 8130 8998</b>	1 year
<b>MAGYARORSZÁG/ Hungary</b>	GRUPE SEB CENTRAL-EUROPE Kft. Tavíro köz 4 2040 Budaörs	<b>(36) 8018434</b>	2 év
<b>INDONESIA</b>	Groupe SEB Indonesia (Representative office) Sudirman Plaza, Plaza Marein 8th Floor JL Jendral Sudirman Kav 76-78, Jakarta 12910, Indonesia	<b>62 21 5793 6881</b>	1 year
<b>ITALIA</b>	GRUPE SEB ITALIA S.p.A. Via Montefeltro, 20156 Milano	<b>1 99 207 892</b>	2 anni
<b>JAPAN</b>	GRUPE SEB JAPAN Co., Ltd. 1F Takanawa Main Building, 3-14-13, Minato-ku, Tokyo, Japan Shinagawa-ku, Tokyo 141-0022	<b>0570-077772</b>	1 year
<b>ҚАЗАҚСТАН KAZAKHSTAN</b>	«Группа СЕБ» ЖШС, 119180 Москва, Ресей Старомонетный рынок, вкш, 14-ый, 2-кварталыс	<b>727 378 39 39</b>	2 жыл / years
<b>KOREA</b>	세브렌 코리아 서울특별시 서린동 88 서린빌딩 3층 1-790	<b>1588-1588</b>	1 year
<b>LATVJA / LATVIA</b>	GRUPE SEB POLSKA SP Z O.O. ul. Ostrobramska 79 04-175 Warszawa	<b>6 716 2007</b>	2 gadi
<b>LIETUVA/ LITHUANIA</b>	GRUPE SEB POLSKA SP Z O.O. ul. Ostrobramska 79 04-175 Warszawa	<b>6 470 8888</b>	2 metai
<b>MACEDONIA</b>	Groupe SEB Bulgaria EOOD Office 1, floor 1, 52G Borovo St., 1680 Sofia - Bulgaria ГРУП СЕБ БЪЛГАРИЯ ДООЕЛ Ул. Борово 52 Г, сп. 1, офис 1, 1680 София, България	<b>(0)2 20 50 022</b>	2 години / years
<b>MALAYSIA</b>	GRUPE SEB MALAYSIA SDN. BHD Lot No. C3A/001 & 002, Block C, Kelana Sq. No.17, Jalan SS7/26, 47301 Kelana Jaya Petaling Jaya, Selangor	<b>65 6550 8900</b>	1 year
<b>MEXICO</b>	G.S.E.B. MEXICANA, S.A. de C.V. Goldsmith 38 Desp. 401, Col. Polanco Delegacion Miguel Hidalgo 11 560 Mexico D.F.	<b>(01800) 112 8325</b>	1 años

 : [www.moulinex.com](http://www.moulinex.com)

			
<b>MOLDOVA</b>	ТОВ «Грун СЕБ Україна» Вул. Драгоманова 31 Б, офіс 1 02068 Київ, Україна	<b>(22) 929249</b>	2 ani / years
<b>NEDERLAND</b>	GGROUPE SEB NEDERLAND BV Generatorstraat 6 3903 LJ Veenendaal	<b>0318 58 24 24</b>	2 jaar
<b>NEW ZEALAND</b>	GROUPE SEB NEW ZEALAND Unit E, Building 3, 195 Main Highway, Ellerslie, Auckland	<b>0800 700 711</b>	1 year
<b>NORGE</b>	GROUPE SEB NORDIC AS Tempovej 27 2750 Ballerup DANMARK	<b>815 09 567</b>	2 år
<b>PERU</b>	GROUPE SEB COLOMBIA Av. Camino Real N° 111 of. 805 B San Isidro - Lima - Perú	<b>+511 441 4455</b>	1 años
<b>POLSKA/ POLAND</b>	GROUPE SEB POLSKA SP Z O.O. ul. Ostrobramska 79 04-175 Warszawa	<b>0 901 300 423</b> koszt. za połączenie lokalne	2 lata
<b>PORTUGAL</b>	GROUPE SEB IBÉRICA SA Urb. da Malinha Rua Projectada à Rua 3 Bloco1 - 3° B/D 1900 - 796 Lisboa	<b>808 284 735</b>	2 anos
<b>REPUBLIC OF IRELAND</b>	GROUPE SEB IRELAND Unit B3 Aerodrome Business Park, Colk, Colk Road, Rathcoole, Co. Du.	<b>01 677 4003</b>	1 year
<b>ROMÂNIA/ ROMANIA</b>	GROUPE SEB ROMANIA Str. Daniel Constantin nr. 8 01061 Bucuresti	<b>0 21 316 87 84</b>	2 ani
<b>РОССИЯ/ RUSSIA</b>	ЗАО «Группа СЕБ Юсти», 119180 Москва, ул. Фрунзенская Старый мостный пер. д.14 стр.2	<b>495 213 32 29</b>	2 года/ years
<b>SRBIJA Serbia</b>	SEB, Development Antifasističke borbe 17/13 1070 Novi Beograd	<b>060 0 732 000</b>	2 godine
<b>SINGAPORE</b>	GROUPE SEB SINGAPORE Pty Ltd. 191 Pempin, #04-01/02 L&Y Building Singapore 577218	<b>65 6550 8900</b>	1 year
<b>SLOVENSKO/ SLOVAKIA</b>	GROUPE SEB SLOVENSKO s.r.o. Rybničná 40 831 07 Bratislava	<b>233 595 224</b>	2 roky
<b>SLOVENIJA</b>	SEB d.o.o. Gregorčičeva ulica 6 2000 MARIBOR	<b>02 234 94 90</b>	2 leti
<b>ESPAÑA</b>	GROUPE SEB IBÉRICA S.A. Almogüers, 119-123, Complejo Ecurban 08018 Barcelona	<b>0902 31 22 00</b>	2 años
<b>SVERIGE</b>	TEFAL SVERIGE SUBSIDIARY OF GROUP SEB NORDIC Truckvägen 14 A, 194 52 Upplands Väsby	<b>08 594 213 30</b>	2 år
<b>SUISSE SCHWEIZ</b>	GROUPE SEB SCHWEIZ GmbH Thurgauerstrasse 105 8152 Glatthbrugg	<b>044 837 18 40</b>	2 ans / Jahre
<b>TAIWAN</b>	SEB ASIA Ltd. Taipei International Building, Suite B2, 6F-1, No. 216, Tun Hwa South Road, Sec. 2 Da-an District Taipei 106, R.O.C.	<b>886-2-27333716</b>	1 year

 : [www.moulinex.com](http://www.moulinex.com)

			
<b>THAILAND</b>	<p>GRUPE SEB THAILAND 2034/66 Italthai Tower, 14th Floor, n° 14-02, New Phetchburi Road, Bangkapi, Huaykwang, Bangkok, 10320</p>	<b>02723 4488</b>	2 years
<b>TÜRKIYE</b>	<p>GRUPE SEB ISTANBUL AS Beybi Giz Plaza Dereboyu Cad. Meydan Sok. No: 28 K.12 Maslak</p>	<b>216 444 40 50</b>	2 YIL
<b>U.S.A.</b>	<p>GRUPE SEB USA 2121 Eden Road Millville, NJ 08332</p>	<b>800-395-8325</b>	1 year
<b>Україна/ UKRAINE</b>	<p>ТОВ «Грун СЕБ Україна» Вул. Драгоманова 31 Б, офіс 1 02068 Київ, Україна</p>	<b>044 492 06 59</b>	2 роки/ years
<b>UNITED KINGDOM</b>	<p>GRUPE SEB UK Ltd. 11-49 Station Road Langley, Slough Berkshire SL3 8 DR</p>	<b>01753 602 1454</b>	1 year
<b>VENEZUELA</b>	<p>GRUPE SEB VENEZUELA Av Eugenio Mendoza, Centro Letonia, Tr ING Bank, Piso 15, Ofc 155 Urb. La Castellana, Caracas</p>	<b>0800-7268724</b>	2 anno
<b>VIETNAM</b>	<p>GRUPE SEB VIETNAM (Rep office) 127-129 Nguyen Hue Street, District 1, Ho Chi Minh City, Vietnam</p>	<b>+84-8 3821 6395</b>	1 year

